

SHIMANO®

1992 REPAIR MANUAL

Shimano American Corporation, One Shimano Dr.
Irvine, CA 92718

※Please check this eared part of the "Dial Case"
here to see whether you have old or new-type reel.

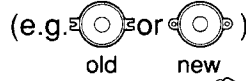

※If your reel has old-type "Dial Case"
as indicated in the exploded view,
parts 1187, 1196 in the box below
the main diagram have been discontinued.
When ordering these specific parts please
order the assembly listed in diagram new
numbers 1257, 1259.
All other parts numbers are as shown in
the exploded view.

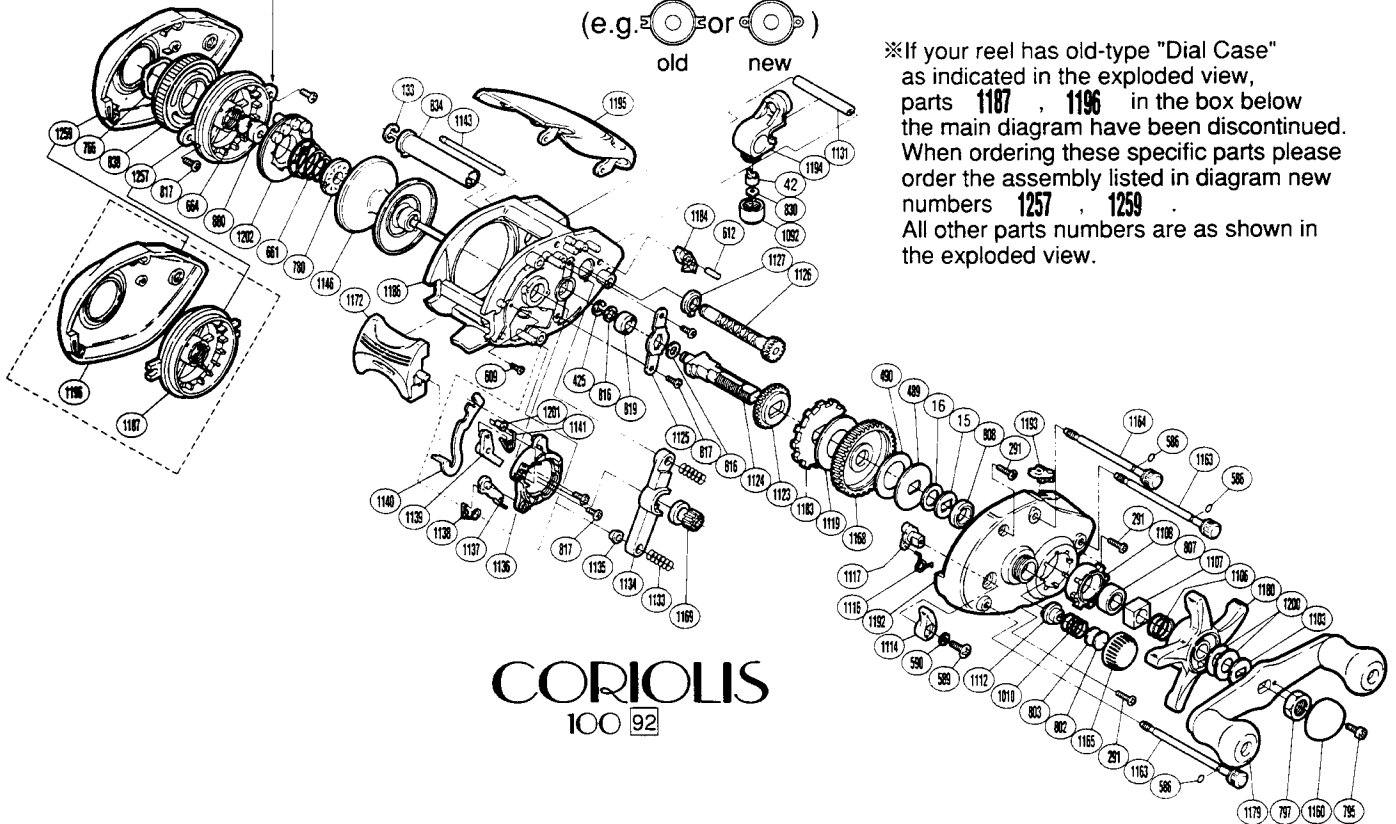

COROLIUS
100 92

BNT No.	PARTS NAMES	BNT No.	PARTS NAMES	BNT No.	PARTS NAMES
0015	Drag Spring Washer	1010	Spool Tension Spring	1164	Side Plate Bolt (B)
0016	Friction Washer (C)	1092	Pawl Cap	1165	Cast Control Cap
0042	Line Guide Pawl	1103	Friction Washer (A)	1168	Drive Gear
0133	Worm Shaft Retainer	1106	Star Drag Spring	1169	Pinion Gear
0291	Right Side Plate Screw	1107	Star Drag Nut	1172	Quick-Fire II Clutch Bar
0425	Drive Shaft Lock	1108	Bearing Holder	1179	Handle Assembly
0489	Key Washer (A)	1112	Spool Shaft Bushing (A)	1180	Star Drag
0490	Drag Washer (B)	1114	Flipping Lever	1183	Anti-Reverse Ratchet
0586	Bolt Retainer	1116	Cam Spring	1184	Anti-Reverse Pawl
0589	Flipping Lever Screw	1117	Flipping Cam	1186	One-Piece Frame
0590	Lock Washer	1119	Drag Washer (A)	1192	Right Side Plate
0609	Clutch Plate Retainer Screw	1123	Idle Gear	1193	Anti-Reverse Switch
0612	Anti-Reverse Pawl Pin	1124	Drive Shaft	1194	Line Guide
0661	Magnet Retainer Spring	1125	Drive Shaft Retainer	1195	Thumb Rest
0664	Spacer (B)	1126	Worm Shaft	1200	Star Drag Spacer
0766	Dial Friction Washer	1127	Worm Bearing	1201	Retractor Spring Collar
0780	Magnet Retainer Lock	1131	Stabilizer Bar	1202	Magnet Retainer
0795	Handle Nut Cover Screw	1133	Yoke Spring	1257	Dial Case
0797	Handle Nut	1134	Yoke	1259	Left Side Plate
0802	Spool Tension Spacer (B)	1135	Yoke Spacer		
0803	Spool Tension Spacer (A)	1136	Clutch Cam		
0807	Drive Shaft Bearing (B)	1137	Clutch Pawl		
0808	Friction Washer (B)	1138	Clutch Pawl Spring		
0816	Drive Shaft Washer	1139	Joint Plate		
0817	Multi Purpose Screw	1140	Clutch Plate		
0819	Drive Shaft Bushing	1141	Retractor Spring		
0830	Spacer (optional)	1143	Thumb Rest Support		
0834	Level Wind Guard	1146	Spool Assembly		
0838	Magnetic Control Dial	1160	Handle Nut Cover	1187	Dial Case
0880	Spool Shaft Bushing (B)	1163	Side Plate Bolt (A)	1196	Left Side Plate

Prices and specifications subject to change without notice

(030508)